

70
Years
1956-2026



STOCK PACKAGES

OVAL STICKS & CAPS

ROUND STICKS & CAPS

JARS & CAPS

CAPS, CLOSURES, LIDS

BOTTLES

PRODUCT CATALOG

REV. 5.1.2026



WWW.PLASTEKGROU.PCOM/STOCK-PACKAGES

World Class Supplier of Your Plastic Needs

Serving Clients globally, The Plastek Group is a trusted global supplier of premium quality injection molding tools and rigid plastic-molded packaging. As an innovative plastics processor, we can provide a wide range of targeted solutions that meet your company's unique challenges. Our 70 years of experience enable us to serve businesses across a broad spectrum of industries.

Stock Packages

Our stock designs are offered in a variety of shapes and sizes, for many general purpose consumer goods. Review options here in this product catalog and find the stock packaging solution for your unique product applications.



Company Introduction Video



Our top fill oval sticks primarily use the propel/repel mechanism with a center screw that moves product up and down. We also carry mini oval packaging options ranging from 0.5 to 1 ounce with the push-up style. In this design, a small platform pushes product upward.

All of our oval propel/repel sticks use polypropylene (PP) for the barrel, cap, and screw. The internal platform is made from high density polyethylene (HDPE). We use a precision injection molding process to achieve precise dimensions. Choose from domed or flat caps for your oval packaging.

TOP FILL PUSH-UP AND PROPEL/REPEL



DIMENSIONS (Inches)

TOP FILL MINI-OVAL PUSH-UP ASSEMBLY with platform; no screw											
FILL WEIGHT		BARREL				FLAT CAP			DOMED CAP		
OZ.	GRAMS	A	B	C	D	X	Y	Z			
0.50	15.00	1.80	1.85	1.87	0.79	1.07	1.88	0.85			
0.75	22.50	1.80	1.85	1.87	1.14	1.07	1.88	0.85			
1.00	30.00	1.80	1.85	1.87	1.49	1.07	1.88	0.85			
TOP FILL PROPEL/REPEL ASSEMBLY with platform and with screw											
11 different platforms are available for each, with the most common listed below. If a fill height needed is not listed, please contact us to inquire about size needed and for the full list of available sizes for our oval propel/repel top fill sticks.											
FILL WEIGHT		BARREL				FLAT CAP			DOMED CAP		
OZ.	GRAMS	A	B	C	D	X1	Y1	Z1	X2	Y2	Z2
SAMPLER (1 OZ.) assembly- available in top-fill only											
0.50	14.29	2.16	2.23	2.18	.348	1.25	2.23	1.18	1.29	2.28	1.40
0.75	21.43	2.16	2.23	2.18	.598	1.25	2.23	1.18	1.29	2.28	1.40
1.00	28.57	2.16	2.23	2.18	.848	1.25	2.23	1.18	1.29	2.28	1.40
TRUE-2 ASSEMBLY											
1.25	35.71	2.16	3.50	2.18	1.30	1.25	2.23	1.18	1.29	2.28	1.40
1.50	42.86	2.16	3.50	2.18	1.54	1.25	2.23	1.18	1.29	2.28	1.40
1.75	50.00	2.16	3.50	2.18	1.79	1.25	2.23	1.18	1.29	2.28	1.40
2.00	57.14	2.16	3.50	2.18	2.04	1.25	2.23	1.18	1.29	2.28	1.40
STANDARD ASSEMBLY											
1.75	50.00	2.16	3.99	2.18	1.79	1.25	2.23	1.18	1.29	2.28	1.40
2.00	57.14	2.16	3.99	2.18	2.04	1.25	2.23	1.18	1.29	2.28	1.40
2.25	64.29	2.16	3.99	2.18	2.29	1.25	2.23	1.18	1.29	2.28	1.40
2.50	71.43	2.16	3.99	2.18	2.54	1.25	2.23	1.18	1.29	2.28	1.40
BONUS OUNCE ASSEMBLY											
2.25	64.29	2.16	4.50	2.18	2.37	1.25	2.23	1.18	1.29	2.28	1.40
2.50	71.43	2.16	4.50	2.18	2.62	1.25	2.23	1.18	1.29	2.28	1.40
2.75	78.57	2.16	4.50	2.18	2.87	1.25	2.23	1.18	1.29	2.28	1.40
3.00	85.71	2.16	4.50	2.18	3.12	1.25	2.23	1.18	1.29	2.28	1.40
SUPER BONUS OUNCE ASSEMBLY											
2.75	78.57	2.16	5.06	2.18	2.87	1.25	2.23	1.18	1.29	2.28	1.40
3.00	85.71	2.16	5.06	2.18	3.12	1.25	2.23	1.18	1.29	2.28	1.40
3.25	92.86	2.16	5.06	2.18	3.37	1.25	2.23	1.18	1.29	2.28	1.40
3.50	100.00	2.16	5.06	2.18	3.62	1.25	2.23	1.18	1.29	2.28	1.40

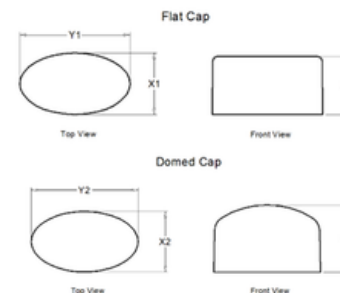
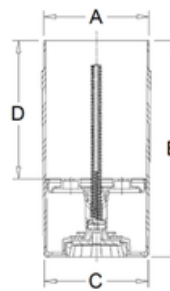
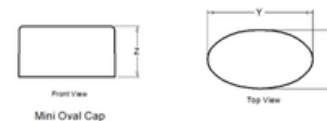
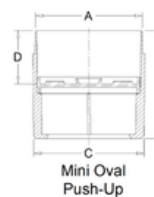

Our bottom fill oval twist-up sticks exclusively use the propel/repel mechanism. These oval containers have two fill holes located on the bottom, which can be more favorable for your workflow or product properties. Small plastic plugs keep product in place upon filling.

BOTTOM FILL PROPEL/REPEL



DIMENSIONS (Inches)

BOTTOM FILL OVAL PROPEL/REPEL ASSEMBLY						
FILL WEIGHT		BARREL			PLUG	
OZ.	GRAMS	B	C	D	X	Z
TRUE-2 ASSEMBLY						
1.30	37.00	2.05	2.167	.889	.28	.25
1.59	45.20	2.05	2.167	1.200	.28	.25
2.12	60.20	2.05	2.167	1.745	.28	.25
BONUS OUNCE ASSEMBLY						
2.25	64.20	5.06	2.167	1.889	.28	.25
2.56	72.70	5.06	2.167	2.20	.28	.25
3.08	87.40	5.06	2.167	2.745	.28	.25

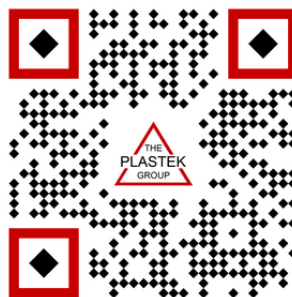
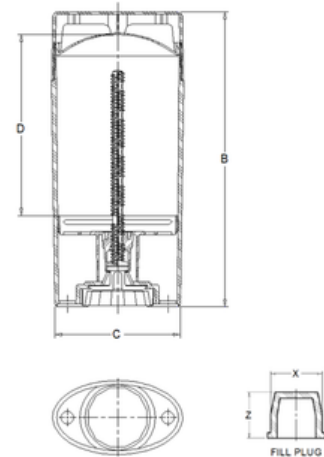

Plastek has two stock designs for soft solid or gel propel/repel containers: Narrow Gel and Wide Gel. Both design options are made from injection molded plastic. The barrel, screw, dome, and cap are made from polypropylene (PP), and the platform is made of high density polyethylene (HDPE). Decoration options are available upon request. Both options are available as top fill only.

NARROW GEL PROPEL/REPEL



Our narrow gel propel/repel sticks feature a slimmer design with three small slits, in the dome covering. This dome design ensures users have control over the amount of product they use. Fill weight for the narrow design is 0.5 ounces to 3.4 ounces.

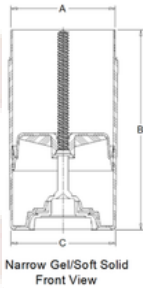

DIMENSIONS (Inches)

OVAL NARROW GEL/SOFT SOLID PROPEL/REPEL ASSEMBLY										
FILL WEIGHT		BARREL			DOME DIMENSIONS			CAP DIMENSIONS		
OZ.	GRAMS	A	B	C	U	V	W	X	Y	Z
.50	14.17	1.24	2.214	2.18	1.322	2.260	.943	1.392	2.332	1.514
2.25	63.81	1.24	4.090	2.18	1.322	2.260	.943	1.392	2.332	1.514
2.82	79.95	1.24	4.589	2.18	1.322	2.260	.943	1.392	2.332	1.514
3.40	96.39	1.24	5.070	2.18	1.322	2.260	.943	1.392	2.332	1.514

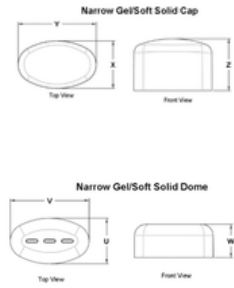

WIDE GEL PROPEL/REPEL



The wide gel stick design uses a dome with a series of small holes for product to push through, offering more product coverage than the narrow design. Fill weight for the wide design is 3 or 4 ounces.

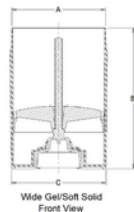

DIMENSIONS (Inches)

OVAL WIDE GEL/SOFT SOLID PROPEL/REPEL ASSEMBLY										
FILL WEIGHT		BARREL			DOME DIMENSIONS			CAP DIMENSIONS		
OZ.	GRAMS	A	B	C	U	V	W	X	Y	Z
3	85.05	1.175	3.915	2.665	1.271	2.734	.927	1.371	2.831	1.477
4	113.40	1.175	4.865	2.665	1.271	2.734	.927	1.371	2.831	1.477

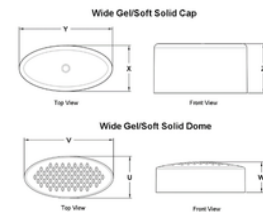

The propel/repel design, or twist-up tube, features an internal corkscrew post that runs through the solid product. As the user twists the bottom, the post spins to move the product upward. Propel/repel tubes have a standard cap design for all tubes except for the smallest lip balm size.

ROUND PROPEL/REPEL



DIMENSIONS (Inches)

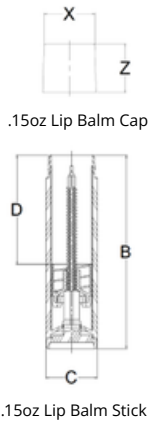

ROUND PROPEL/REPEL ASSEMBLY- Available in Top-fill						
FILL WEIGHT		BARREL			CAP	
OZ	GRAMS	B	C	D	X	Z
0.15	4.25	2.22	0.62	1.32	0.624	0.583
0.75	21.43	2.03	1.59	0.91	1.56	1.60
2.20	57.14	3.90	1.59	2.49	1.54	1.60
3.00	85.71	5.01	1.59	3.29	1.56	1.60
4.50	128.57	6.13	1.59	5.02	1.56	1.60

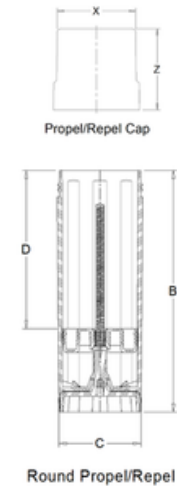

The barrel, screw, and cap of our round sticks are made from polypropylene (PP). The platforms are made from high density polyethylene (HDPE). We apply a plastic injection molding process to create round stick packaging for various applications.

Round push-up sticks use a simple internal mechanism to move product up to the top of the tube. A small platform inside the tube holds the solid product and moves the product upward. Push-up tubes have various cap types based on the size of the packaging.

ROUND PUSH-UP



DIMENSIONS (Inches)

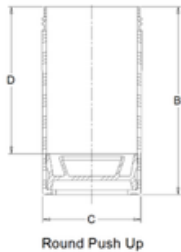

ROUND PUSH-UP ASSEMBLY Top-fill assemblies with platform only, no screw

FILL WEIGHT		BARREL			CAP	
OZ	GRAMS	B	C	D	X	Z
2.50	70.87	3.00	1.78	2.30	1.77	1.52
2.75	78.57	3.42	1.81	2.67	1.77	1.52
3.00	85.71	3.03	1.80	2.38	1.90	1.27

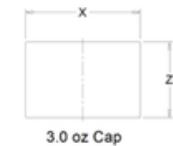
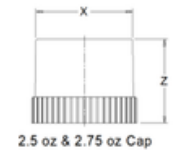

The barrel and cap of our round sticks are made from polypropylene (PP). The platforms are made from high density polyethylene (HDPE). We apply a plastic injection molding process to create round stick packaging for various applications.

Upon selection of the choice fill weight, please note our stock barrels are offered with the corresponding cap styles as referenced in the drawings above. Serrated Cap only available in sizes 2.5oz & 2.75oz. Smooth Cap only available in size 3.0oz.

Single Wall: Straight base jars with a single wall work for a wide range of products. We can manufacture these jars with polypropylene (PP), polystyrene (PS), or styrene acrylonitrile (SAN) resin. Choose from organic frost or smooth finish.

Double Wall: Straight base jars with a double wall design have an interior wall and an exterior wall. The interior jar holds the product, and the exterior layer adds extra protection. Double wall exteriors come in polypropylene (PP), polystyrene (PS), or styrene acrylonitrile (SAN) resin. Interior jars are made from polypropylene only. Available finishes include in-mold frost, organic frost, and smooth.

STRAIGHT BASE JARS



DIMENSIONS (Inches)

STRAIGHT BASE JAR - SINGLE WAL												
FILL WEIGHT		JAR		CAP THREADS				CAP SIZE	AVAILABLE CAP STYLES			
OZ	ML	B	C	T		E		MM	STRAIGHT	CLASSIC	DOMICAL	DOME
0.50	15	1.120	1.141	1.290	1.270	1.250	1.230	33	33 Special cap only			

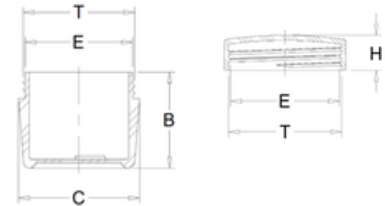

DIMENSIONS (Inches)

STRAIGHT BASE JAR - DOUBLE WAL												
FILL WEIGHT		JAR		CAP THREADS				CAP SIZE	AVAILABLE CAP STYLES			
OZ	ML	B	C	T		E		MM	STRAIGHT	CLASSIC	DOMICAL	DOME
0.25	7	1.015	1.420	1.265	1.241	1.171	1.147	33			△	
*.50	14	1.290	2.045	1.870	1.840	1.776	1.746	48	△	△	△	
*1	36	1.600	2.160	1.968	1.933	1.874	1.839	51	△	△		
*1	40	1.600	2.160	2.067	2.032	1.973	1.938	53	△		△	△
*2	57	1.940	2.360	2.224	2.189	2.130	2.095	58	△	△	△	△
3	85	2.235	2.595	2.461	2.426	2.367	2.332	63	△	△		
*4	114	2.430	2.910	2.736	2.701	2.642	2.607	70	△	△	△	△
6	170	2.945	3.075	2.913	2.878	2.819	2.784	75	△			
*8	227	2.870	3.410	3.268	3.233	3.148	3.133	83	△			△

*Available as in-mold frost or polished finish

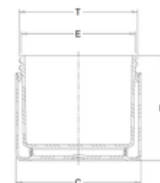

Double Wall: Round base jars with a double wall design have an interior wall and an exterior wall. The interior jar holds the product, and the exterior layer adds extra protection. Double wall exteriors come in polypropylene (PP), polystyrene (PS), or styrene acrylonitrile (SAN) resin. Interior jars are made from polypropylene only. Available finishes include in-mold frost, organic frost, and smooth.

ROUND BASE JARS



DIMENSIONS (Inches)

ROUND BASE JAR - DOUBLE WAL

FILL WEIGHT		JAR		CAP THREADS				CAP SIZE	AVAILABLE CAP STYLES			
OZ	ML	B	C	T		E		MM	STRAIGHT	CLASSIC	DOMICAL	DOME
0.5	14	1.290	2.045	1.870	1.840	1.760	1.746	48	△	△	△	
1	36	1.600	2.160	1.968	1.330	1.874	1.839	51	△	△		
1	40	1.600	2.160	2.067	2.032	1.973	1.938	53	△		△	△
*2	57	1.940	2.360	2.224	2.189	2.130	2.095	58	△	△	△	△
*4	114	2.430	2.910	2.736	2.701	2.642	2.607	70	△	△	△	△

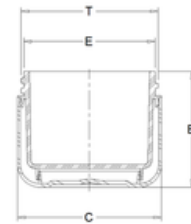

*Available as in-mold frost or polished finish

Caps and closures have a major impact on user experience, so picking the right one is essential. These parts must be produced with the utmost quality control to ensure they twist onto jars tightly and keep the product secure. At Plastek, our selection of cap designs offers the quality manufacturing your packaging needs.

Our plastic caps and closures are designed for our straight and round base jars. Choose a design that best fits your brand and the feel of your product.

DIMENSIONS (Inches)

ROUND & STRAIGHT BASE JAR CAPS				
CAP SIZE	MAX. CAP DIAMETER	CAP HEIGHT	CAP THREADS	
MM		H	T	E
STRAIGHT SIDE CAP				
33	1.410	.458	1.287 / 1.266	1.193 / 1.172
48	2.005	.455	1.892 / 1.871	1.798 / 1.777
51	2.070	.450	1.990 / 1.969	1.896 / 1.875
53	2.175	.450	2.089 / 2.068	1.995 / 1.974
58	2.347	.455	2.246 / 2.225	2.152 / 2.131
63	2.585	.460	2.483 / 2.462	2.389 / 2.368
70	2.905	.480	2.758 / 2.737	2.664 / 2.643
75	3.045	.452	2.935 / 2.914	2.841 / 2.820
83	3.410	.532	3.293 / 3.269	3.173 / 3.149
CLASSIC CAP				
48	2.010	.763	1.892 / 1.871	1.798 / 1.777
51	2.110	.820	1.990 / 1.969	1.896 / 1.875
58	2.375	.875	2.246 / 2.225	2.152 / 2.131
63	2.600	.845	2.483 / 2.462	2.389 / 2.368
70	2.095	.925	2.758 / 2.737	2.664 / 2.643
DOME CAP				
53	2.165	.675	2.089 / 2.068	1.995 / 1.974
58	2.350	.675	2.246 / 2.225	2.152 / 2.131
70	2.895	.685	2.758 / 2.737	2.664 / 2.643
83	3.410	.875	3.293 / 3.269	3.173 / 3.149
DOMICAL CAP				
33	1.410	.560	1.287 / 1.266	1.193 / 1.172
48	2.025	.600	1.892 / 1.871	1.798 / 1.777
53	2.175	.643	2.089 / 2.068	1.995 / 1.974
58	2.355	.640	2.246 / 2.225	2.152 / 2.131
70	2.915	.620	2.758 / 2.737	2.664 / 2.643

The Plastek Group offers a wide range of stock cap designs to work with our straight and round base jars. These options include:

- **Straight Side:** Our straight side caps are short in height with no rounding. This design can offer a contemporary feel for your jarred products. Our straight side caps have the widest size range of our stock cap designs.
- **Classic:** The classic cap offers the tallest height and includes a slight rounding along the top.
- **Domed:** The fully rounded corners of the domed cap add a more organic feel to your jar's design. Pair the domed cap with the round jar for softness on all edges.
- **Domical:** Our domical cap is the moderate option between the domed and straight side cap. The edges are slightly rounded.



Straightside Cap



Classic Cap



Domed Cap

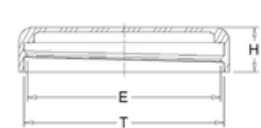

Domical Cap

Our container caps are injection molded with high-density polyethylene (HDPE) and FDA-approved resin for a smooth finish. A ribbed circumference improves user experience and is available in stock natural, white, and black. We can also create custom colors if required. Available as 89mm or 110mm.

The standard cap design comes without a liner, but we can include one upon request. Material options may include foam, foil, and heat induction seals.

CONTAINER CAP



89mm Cap: Our 89mm cap is 0.64 inches tall and features threads that conform to SPI standards for 400 finish closures.

DIMENSIONS (Inches)

CAPS, CLOSURES, LIDS				
CAP SIZE	MAX CAP DIAMETER	CAP HEIGHT	CAP THREADS	
MM	D	H	T	E
89MM – 400 CONTAINER CAP				
89	3.675	.644	3.524	3.420

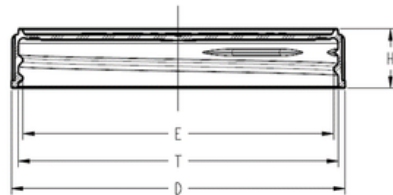

110mm Cap: The larger 110mm cap is 0.69 inches tall. This cap design also has threads that align with SPI standards for 400 finish closures.

DIMENSIONS (Inches)

CAPS, CLOSURES, LIDS				
CAP SIZE	MAX CAP DIAMETER	CAP HEIGHT	CAP THREADS	
MM	D	H	T	E
110MM – 400 CONTAINER CAP				
110	4.494	.685	4.348	4.232

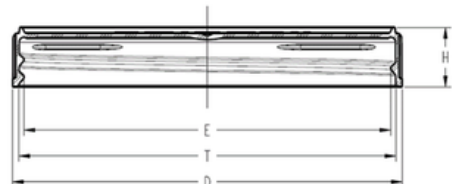

The Flip Top Dressing Cap is injection molded using polypropylene (PP) to create the functional flip top lid that can be snapped open and closed with superior resistance to impact. This cap is designed ideally for condiments/dressings with a creamy or liquid consistency. Compatible with neck 28-1881. Available in custom colors upon request.

DRESSING CAP / (FLIP-TOP)

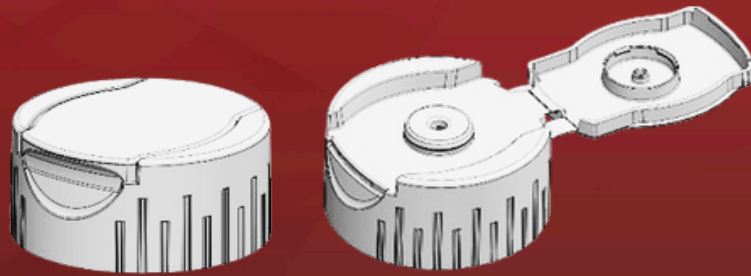
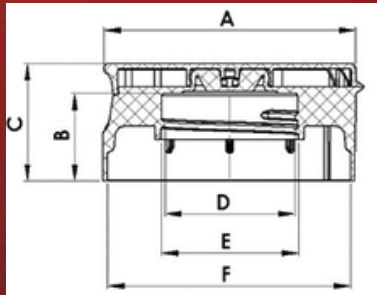

DIMENSIONS (Millimeters/Inches)

CAPS, CLOSURES, LIDS

ITEM	A		B		C		D		E		F	
	MM	IN	MM	IN	MM	IN	MM	IN	MM	IN	MM	IN
CAP50 MM PCO 28-1881	51.00	2.007	17.800	0.700	23.900	0.940	26.300	1.035	27.800	1.094	49.300	1.940

38 mm PCO-threaded cap made of HDPE with food-grade colorants, compatible with PCO-38 finish bottles.

It features a double-seal system (inner and outer plug) and a segmented tamper-evident band. The ribbed surface improves grip and ergonomics during opening and closing.

Suitable for plastic bottles across multiple segments and for degassed liquid, semi-liquid, or solid products such as juices, dairy products, coconut water, capsule or powder supplements, and other solids, provided prior compatibility testing and validation.

38MM STANDARD CAP

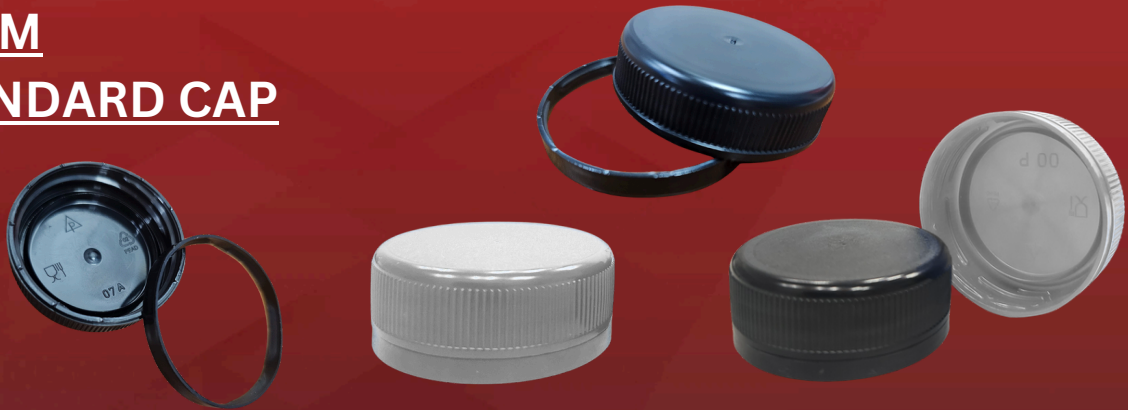

DIMENSIONS (Millimeters/Inches)

CAPS, CLOSURES, LIDS										
CAP SIZE	MAX CAP DIAMETER		CAP HEIGHT		THREADS				PLUG SEAL DIAMETER	
	MM	EXTERNAL	H		T		E		I	
38MM STANDARD CAP	MM	IN	MM	IN	MM	IN	MM	IN	MM	IN
38	39.50	1.55	15.50	0.61	36.45	1.43	35.90	1.41	32.80	1.29

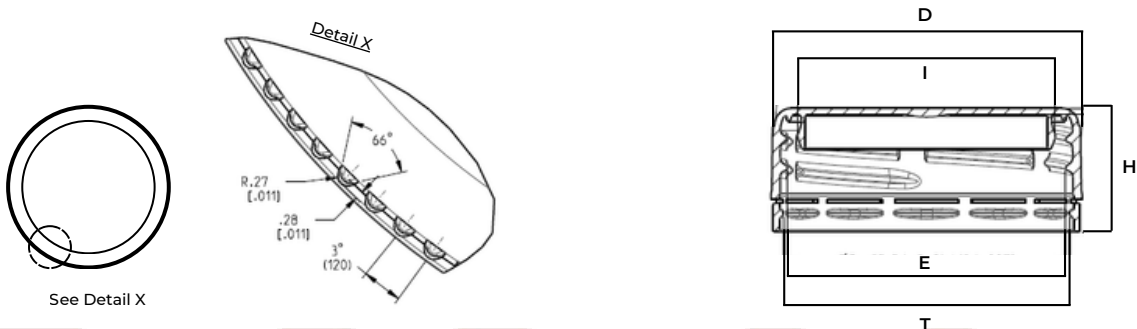

Our Liquor/Spirits (Dosing Cap) for alcoholic beverages is manufactured with a carefully designed injection and assembly process. With a reliable dosing mechanism and robust construction, this cap provides a smooth and consistent service experience while safeguarding your brand against counterfeiting and refilling, also eliminating waste and unwanted spills when served.

LIQUOR/SPIRITS CLOSURE

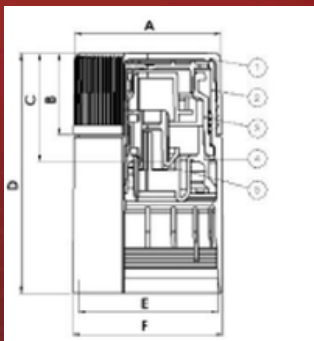

ASSEMBLY 1

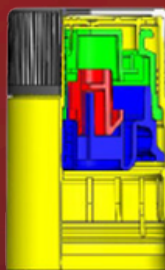

ASSEMBLY 2

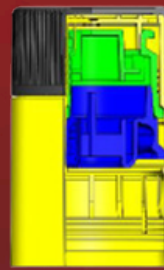

APPLICATION



DIMENSIONS (Millimeters/Inches)

CAPS, CLOSURES, LIDS

ITEM	COMPONENT	MATERIAL	A		B		C		D		E		F	
			MM	IN	MM	IN	MM	IN	MM	IN	MM	IN	MM	IN
LIQUOR/SPIRITS CLOSURE														
CG 28x50-5 WITH BOTTLE LOCK- STANDARD ASSEMBLY 1			31.60	1.24	17.00	0.67	22.80	0.90	51.1	2.01	30.2	1.19	32.6	1.28
1	OVER CAP 2851/5R	HDPE												
2	SKIRT CAP 2850/5R	HDPE												
3	CALOTTE 2851/5R	PS CRYSTAL												
4	BASE 2850/5R	LDPE												
5	METERING VALVE 2851/5R	HDPE												

DIMENSIONS (Millimeters/Inches)

CAPS, CLOSURES, LIDS

ITEM	COMPONENT	MATERIAL	A		B		C		D		E		F	
			MM	IN	MM	IN	MM	IN	MM	IN	MM	IN	MM	IN
LIQUOR/SPIRITS CLOSURE														
CG 28x50-54 WITH BOTTLE LOCK- STANDARD ASSEMBLY 2			31.60	1.24	17.00	0.67	22.80	0.90	51.1	2.01	30.2	1.19	32.6	1.28
1	OVER CAP 2851/5R	HDPE												
2	SKIRT CAP 2850/5R	HDPE												
3	CALOTTE 2851/5R	PS CRYSTAL												
4	BASE 2850/5R	LDPE												

The Plastek Group offers one stock dust cover cap that is suitable for aerosol cans needing a 214 Neck-in-Hook (NIH) cap. These 214 caps have a 2.788 inch diameter and measure 2.15 inches tall. We can work with your team to develop a custom color based on your branding.

All stock dust cover caps are made from polypropylene and feature a standard NIH design along the opening. This design allows for easy push and pull action from applying and removing the cap. A snap signifies that the cap is firmly in place.

Our aerosol can caps work for a wide range of industries. Personal care and beauty products like shaving creams and hairspray often use this cap type. Home care items like disinfectants, surface cleaners, and air fresheners also need these caps. In construction, spray paint uses these caps.

DUST COVER CAP



DIMENSIONS (Inches)

CAPS, CLOSURES, LIDS				
CAP SIZE	MAX CAP DIAMETER	CAP HEIGHT	CAP THREADS	
MM	D	H	T	E
214 DUST COVER CAP				
-	2.788	2.150	-	-

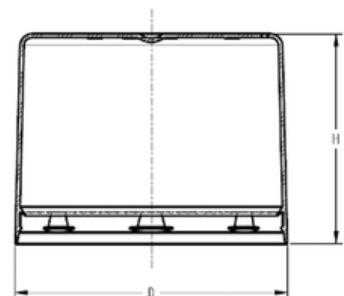

No packaging is complete without a reliable closure. Our stock Cap & Spout product is a staple in households worldwide. A dosing cup and pour combination like this is ideal for consumer home care, such as liquid detergents, fabric softeners, cleaners, and disinfectants.

LLD CAP-LINED

Features:

- Dispense Dosage Guide- fill dosage increments labeled inside the cap for levels; A, B, and 1 through 8.
- The standard cap design comes without a liner, but we can include one upon request.

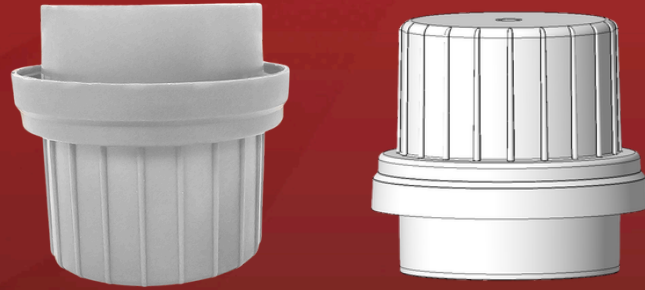

DIMENSIONS (Inches)

CAPS, CLOSURES, LIDS					
CAP SIZE	CAP DIAMETER	CAP HEIGHT	MAX CAP WIDTH	CAP THREADS	
MM	A	B	C	T	E
LLD Cap					
70	2.300	2.625	2.874	2.747	2.652

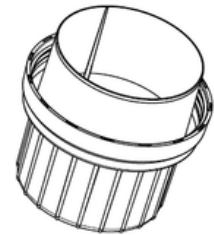
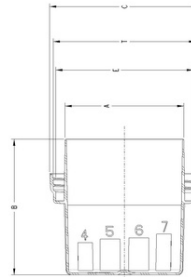

LLD PUSH-IN SPOUT

Features:

- Secure Spout to Bottle Connection
- Pre assembled Cap & Spout shipment
- Spout design for ideal flow for liquid pour dispensing



DIMENSIONS (Inches)

CAPS, CLOSURES, LIDS				
CAP SIZE	MAX SPOUT HEIGHT	SPOUT HEIGHT2	SPOUT WIDTH	SPOUT DIAMETER
MM	B	B2	C	D
LLD PUSH-IN SPOUT				
70	2.521	1.456	2.5	2.558

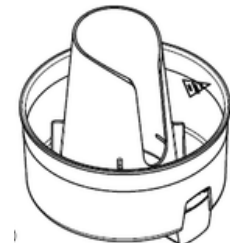
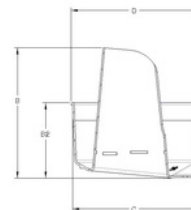

Our disc top cap is the ideal solution for functional, and practical packaging. Designed with durable materials and an ergonomic format, it allows quick opening and closing with just one touch, delivering convenience and safety to the consumer. Easy to use, compatible with bottles of different volumes, perfect for cosmetics, shampoos, conditioners, liquid soaps, creams, and personal. Dosage control, ensures precise product dispensing, reducing waste.

Compatible with a 24-410 neck, we manufacture this stock product using polypropylene (PP), and in stock colors of white, black, green, brown, and blue.

DISC TOP CAP

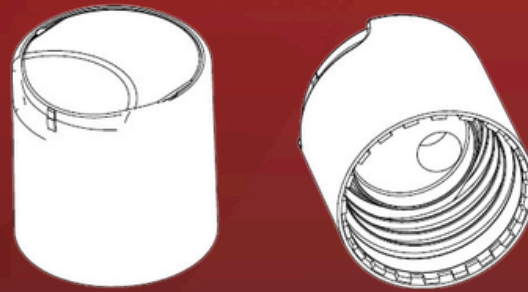

DIMENSIONS (Millimeters/Inches)

CAPS, CLOSURES, LIDS

CAP SIZE	MAX CAP DIAMETER		CAP HEIGHT		THREADS						PLUG SEAL DIAMETER	
	D EXTERNAL		H		h		T		E		I	
MM	MM	IN	MM	IN	MM	IN	MM	IN	MM	IN	MM	IN
DISC TOP CAP	MM	IN	MM	IN	MM	IN	MM	IN	MM	IN	MM	IN
24	27.25	1.07	27.25	1.07	16	0.63	24.11	0.95	21.95	0.86	18.65	0.73

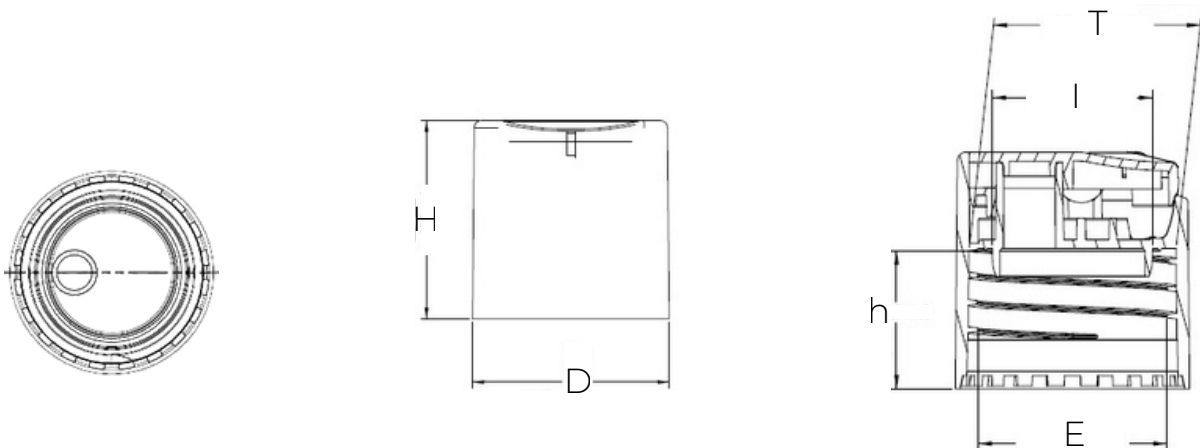

Flip-top closures are excellent cap designs that work well for various products. These closures are often found in health and beauty and personal care items, such as shampoos, hand sanitizers, and lotions. In the food and beverage industry, they are used for condiments, dressings, and sauces. Available as 24mm or 28mm.

FLIP-TOP CAP



24mm Flip-Top: Our 24mm flip-top bottle caps are the smaller of our two stock designs in this category. The height of this cap measures just over 0.8 inches and has a tight arrangement of threads inside for a snug fit on smaller bottles.

DIMENSIONS (Inches)

CAPS, CLOSURES, LIDS				
CAP SIZE	MAX CAP DIAMETER	CAP HEIGHT	CAP THREADS	
MM	D	H	T	E
24MM FLIP TOP CAP				
24	1.086	.805	.956	.868

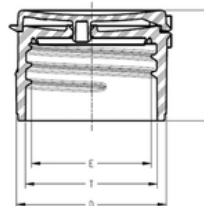

28mm Flip-Top: The 28mm flip-top cap has a slightly wider diameter with a more squat design. The cap is about 0.76 inches tall and has wider threads that are more suitable for larger bottles.

DIMENSIONS (Inches)

CAPS, CLOSURES, LIDS				
CAP SIZE	MAX CAP DIAMETER	CAP HEIGHT	CAP THREADS	
MM	D	H	T	E
28MM FLIP TOP CAP				
28	1.194	.768	1.110	1.035

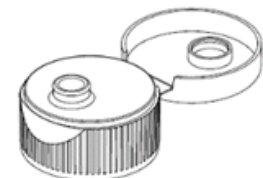
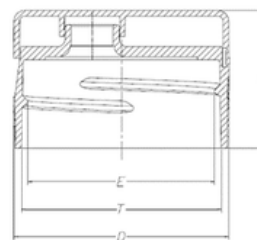

Boston Round Bottles have traditionally been used in industries such as; health and wellness in the past, but there has been a recent shift into many other industries that require the containment of liquids, balms, lotions, and more.

Our 8oz. Round Blow Molded Straight Wall Bottle is made of polyethylene allowing for a semi-rigid design with ideal form and function. The cylindrical shape with a curved, low profile shoulder, featuring a slender neck threaded, and compatible with Plastek's stock 24mm-410 Flip-Top Cap.

BOSTON ROUND



DIMENSIONS (Inches)

BOTTLES						
FILL WEIGHT		BOTTLE		NECK		CAP SIZE
OZ	ML	B	C	T	E	MM
BOSTON ROUND BOTTLE						
8	236	5.22	2.25	.932	.848	24-410

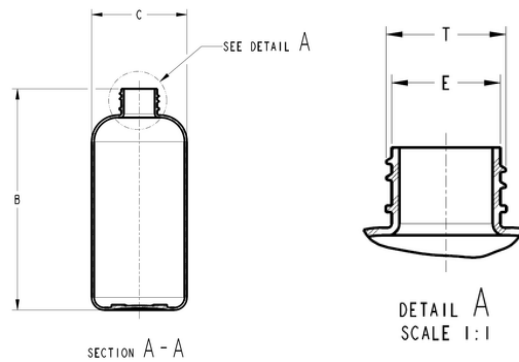

The Plastek Group, Where Innovation Matters!

We appreciate the opportunity to further strengthen our partnership, whether you're an existing customer expanding or updating your business portfolio, or a new prospective client seeking to establish a relationship with Plastek. Thank you in advance for considering us, and we look forward to fostering a mutually beneficial relationship together.



Eric Chilton
Plastek Global Accounts
V.P. of Sales



Brian Galla
Sr. Packaging Specialist
& New Business Development

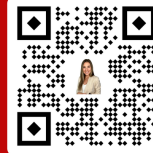

Kierstyn O'Brien
New Business Development



John Heinrichson
V.P. of Tooling Sales



Phil Bongiorno
Sr. Account Manager



Robert Slayton
Sr. Account Manager



Ronald Brzezicki
Sr. Account Manager



Gabriel Prischak
Sales & Account Manager

PLASTEK US



814-878-4400



SALESINQUIRY@PLASTEKGROUP.COM



Derek Woodruff
Plastek UK
Sales Director



Daniel Kelk
Plastek UK
New Business Development

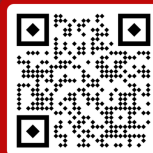

Drew Larcombe
Plastek UK
New Business Development

PLASTEK UK



01623 662233



UKSALES@PLASTEKGROUP.COM



Julio Cruz Lima Neto
Plastek Brazil
Sales Director



Silvana Morita G. da Costa
Plastek Brazil
Sr. Sales Account Manager

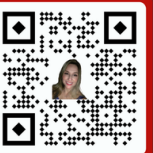

Viviane Sperandio
Plastek Brazil
Sr. Sales Coordinator



Marcio Vieira
Plastek Brazil
Sr. Sales Coordinator

PLASTEK BRAZIL



01623 662233



JULIO.CRUZLIMA@PLASTEKGROUP.COM



Alberto Borrajo
Plastek Mexico
Director de Ventas/Vicepresidente de Ventas Globales y Director General



Daniel Bello
Plastek Mexico
Sales Manager



David Borrajo
Plastek Mexico
New Business Development

PLASTEK MEXICO



52-442-296-7510



CONTACTO@PLASTEKGROUP.COM

GET IN TOUCH



814-878-4400 (U.S.)



SALESINQUIRY@PLASTEKGROUP.COM



"THE PLASTEK GROUP"



70
Years
1956-2026

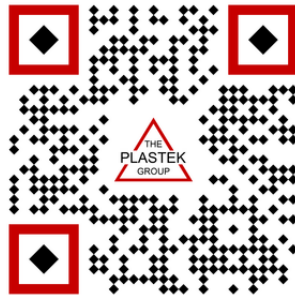

**Visit our website for more information
on Plastek Stock Packages & Product Offerings**



WWW.PLASTEKGROUP.COM/STOCK-PACKAGES

70
Years
1956-2026



WWW.PLASTEKGROUP.COM/STOCK-PACKAGES